

D 147 Bolton St.

IRENET CONTROL STATION

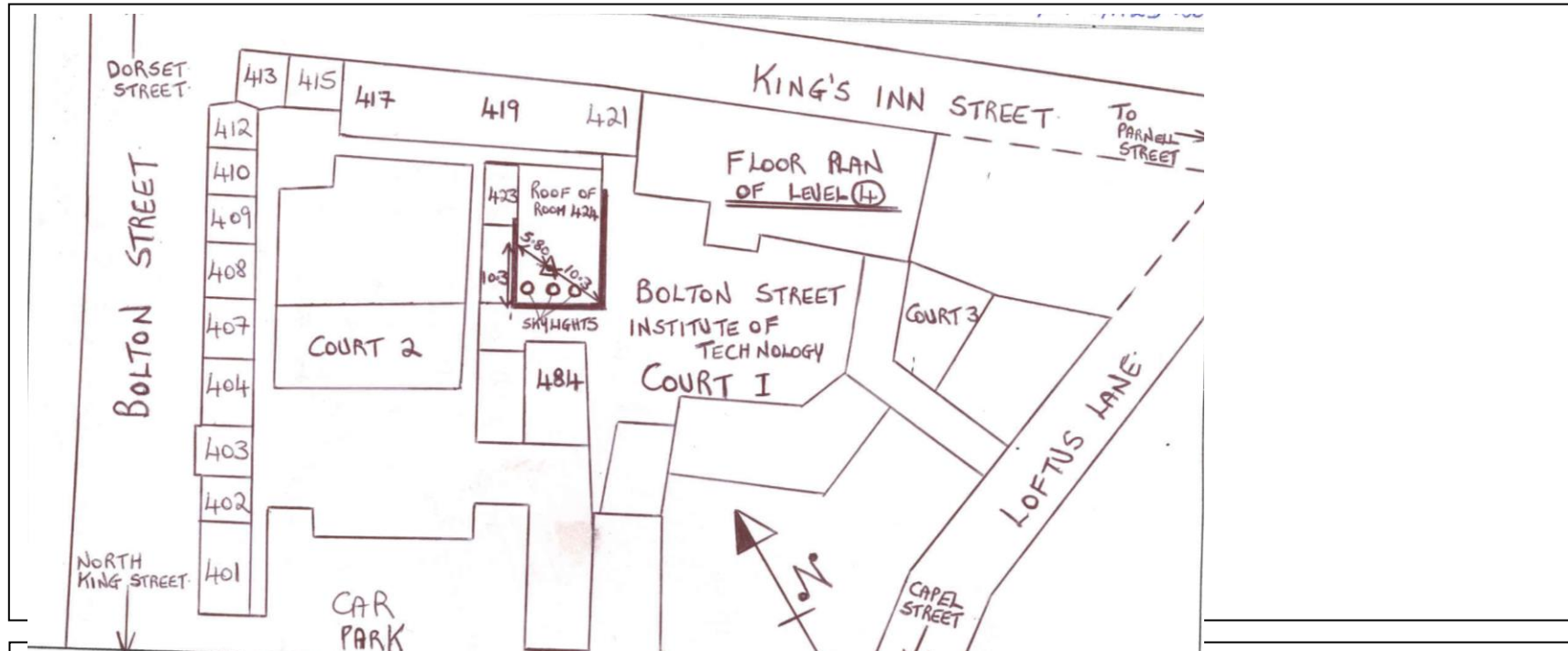

IRENET-95 COORDS. (ETRF89)

LAT 53° 21' 05.51492"
LONG. -06° 16' 06.88664"
ELLIP. HT. 81.3140

ITM COORDINATES

Easting: 715270.637
Northing: 734876.884
Ht. (MSL mts)

IRISH GRID COORDINATES

Easting: 315344.951
Northing: 234850.721
Ht. (MSL mts) 25.186

WRITTEN DESCRIPTION

This station consists of a concrete block with alluminium nail in center set on top of roof of room 424 of Level 4 of Dublin Institute of Technology in Bolton Street. Measurements are taken to outer edge of surrounding wall on roof. Access through door (414) near lift on level 4.

Note: All measurements shown are in metres. Sketch is not to scale.

GEODETIC SURVEYOR :

DATE: 1995